

ACESSO - ENTORNO - ARQUIBANCADA  
Esc.: 1/150

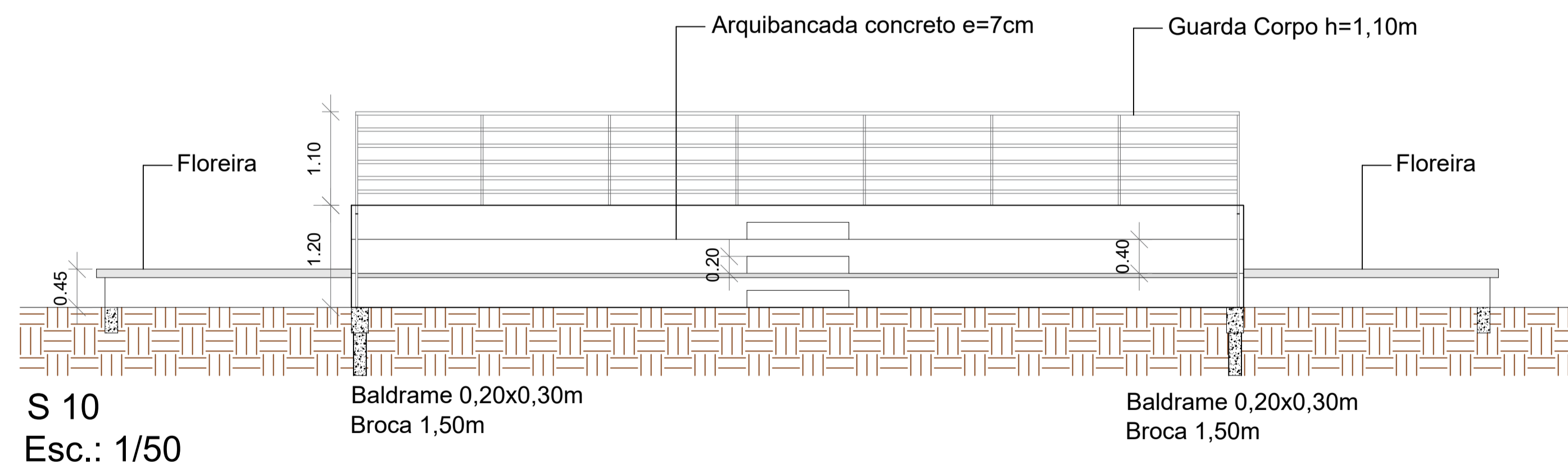

S 10  
Esc.: 1/50

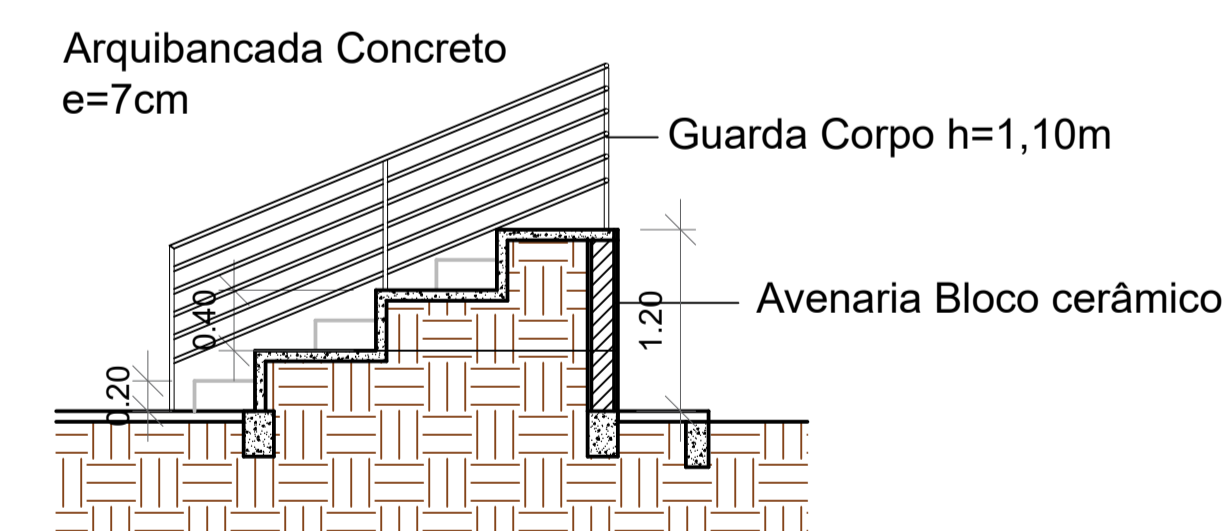

S 11  
Esc.: 1/50

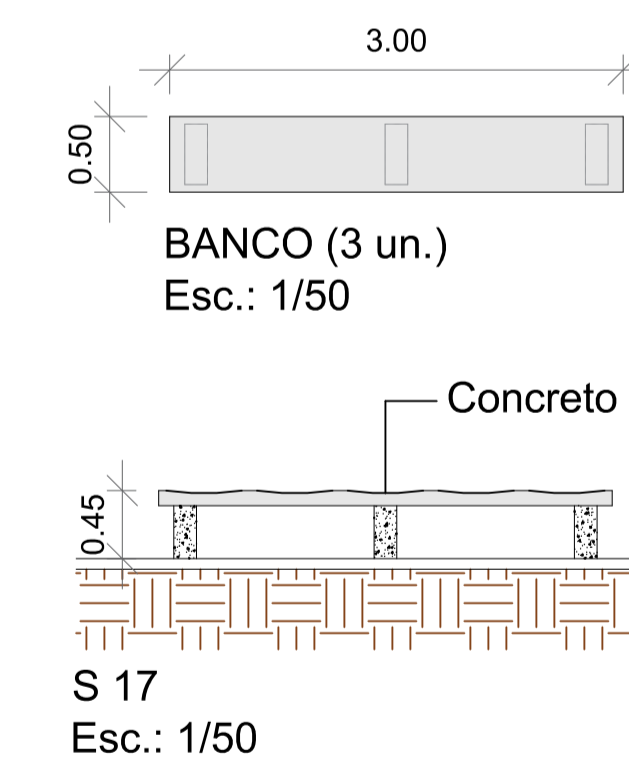

BANCO (3 un.)  
Esc.: 1/50

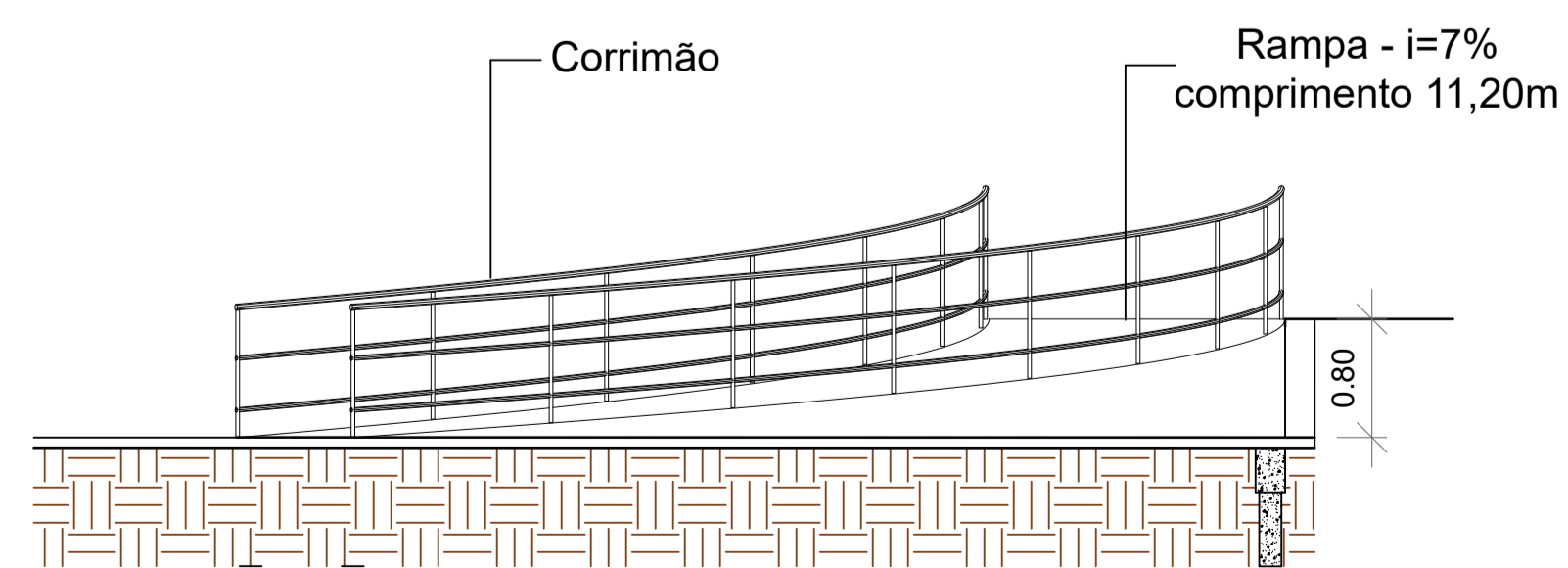

S 12  
Esc.: 1/50

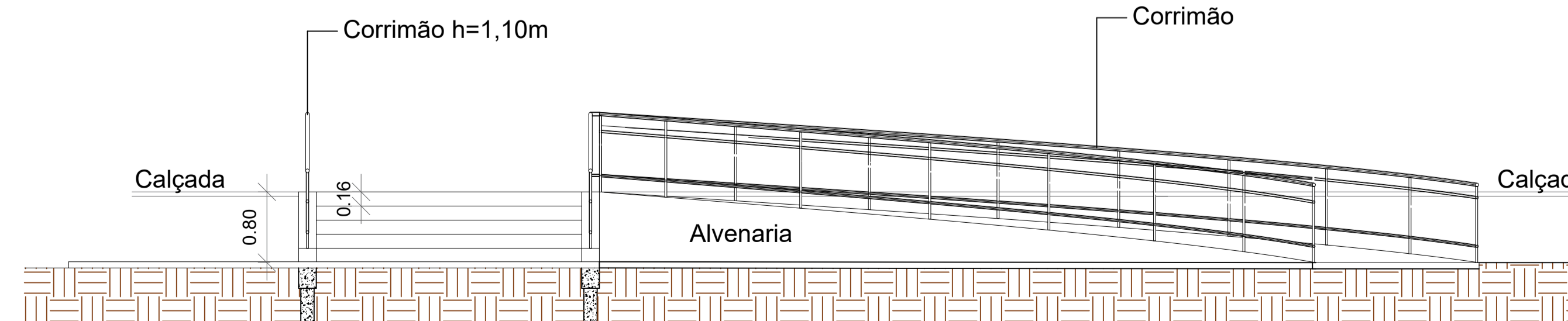

S 13  
Esc.: 1/50

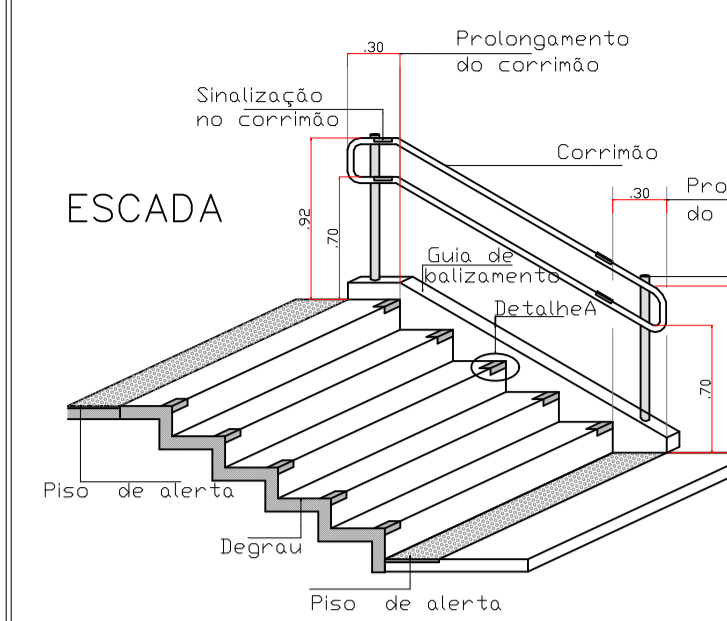

PERSPECTIVA

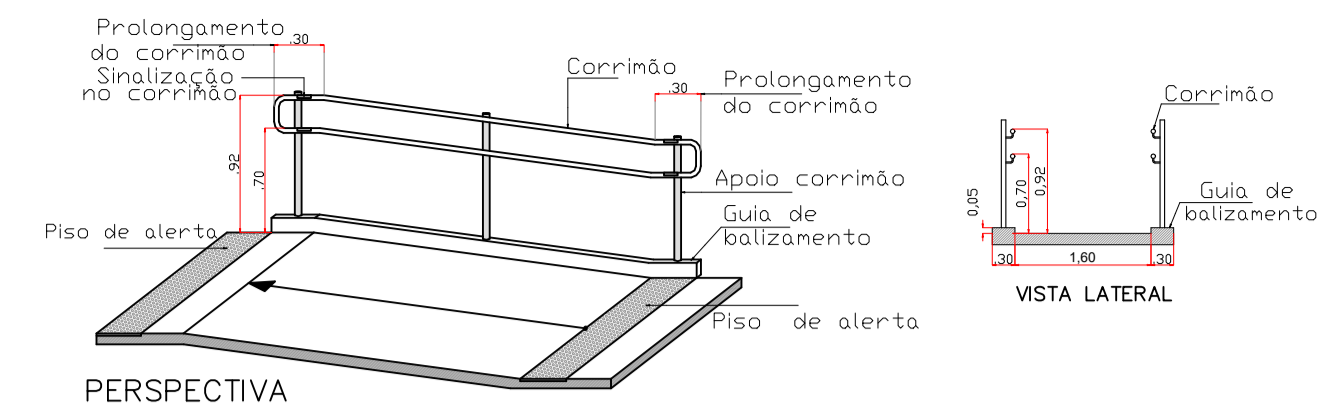

PERSPECTIVA

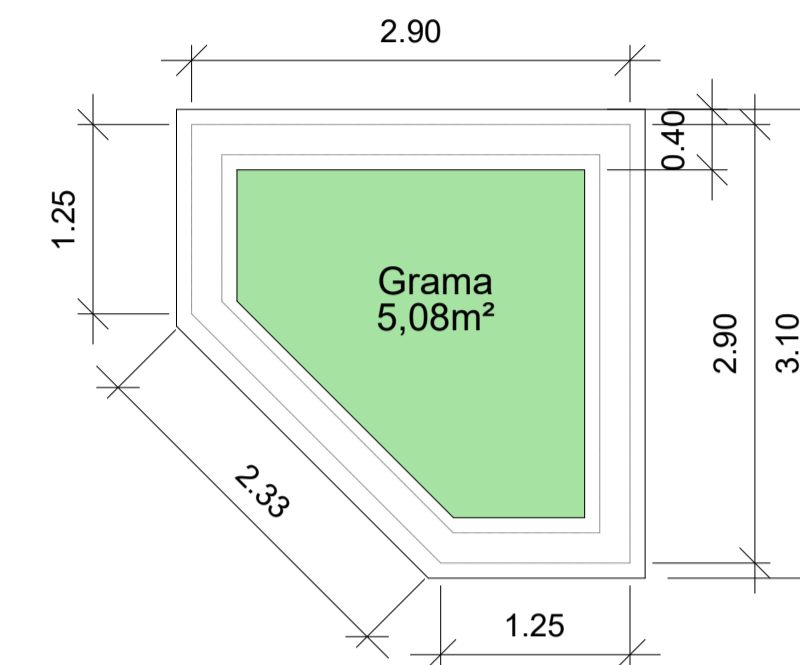

PLANTA FLOREIRA (4 un.)  
Esc.: 1/50

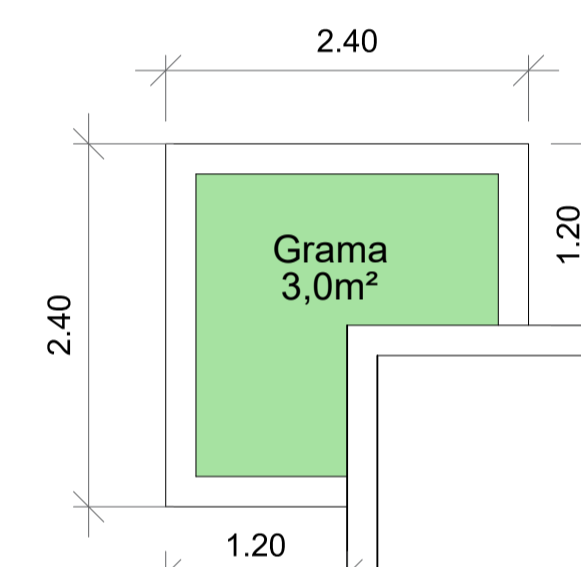

PLANTA FLOREIRA (2 un.)  
Esc.: 1/50

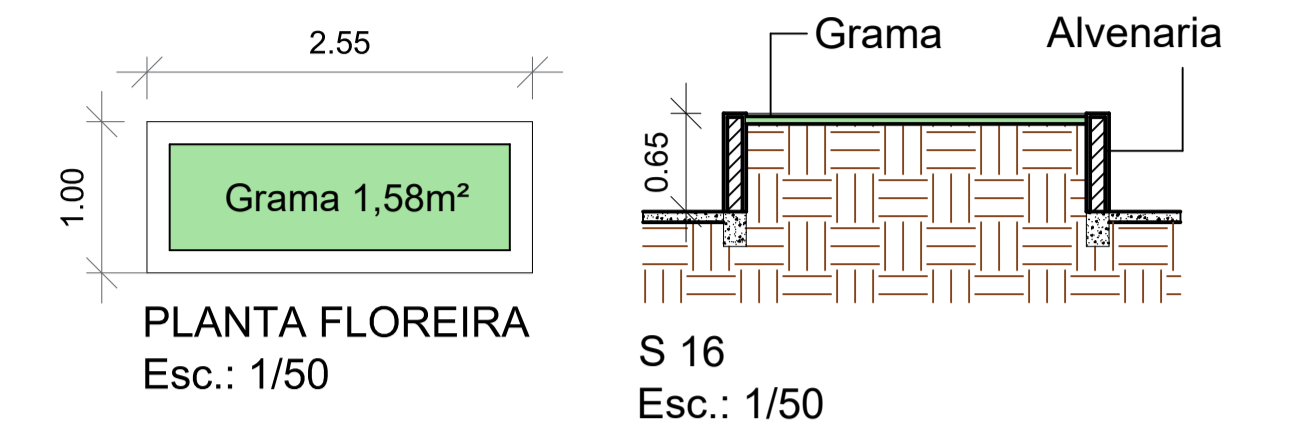

PLANTA FLOREIRA  
Esc.: 1/50

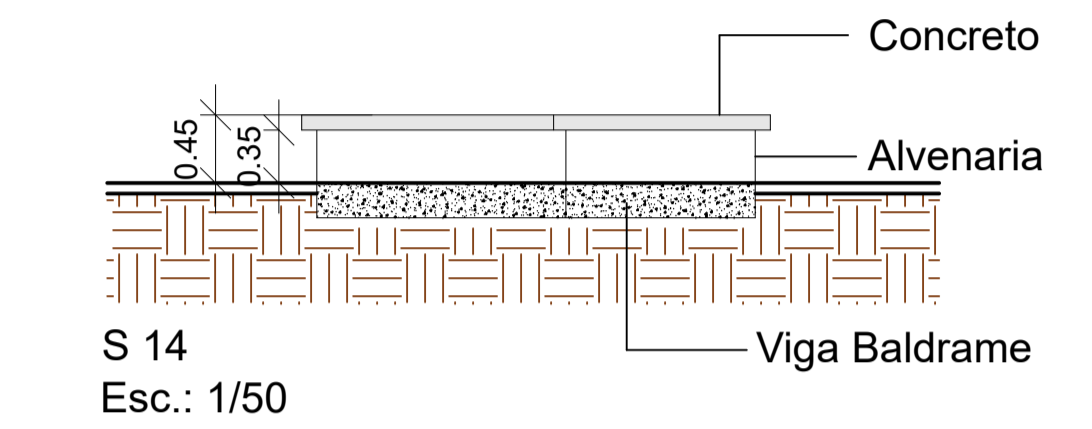

S 14  
Esc.: 1/50

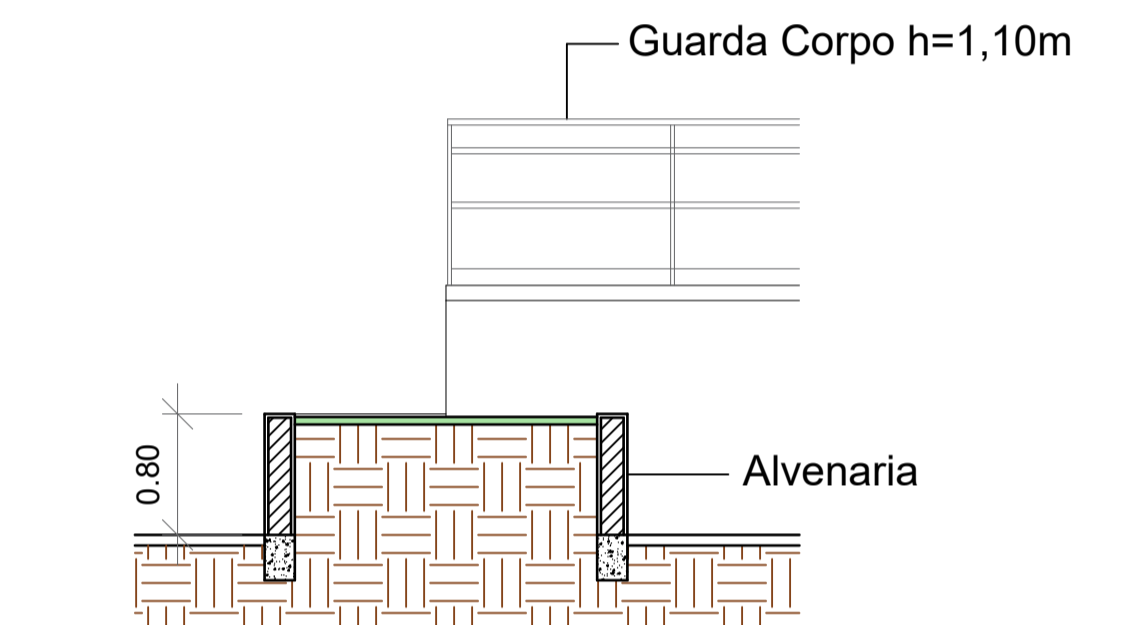

S 15  
Esc.: 1/50

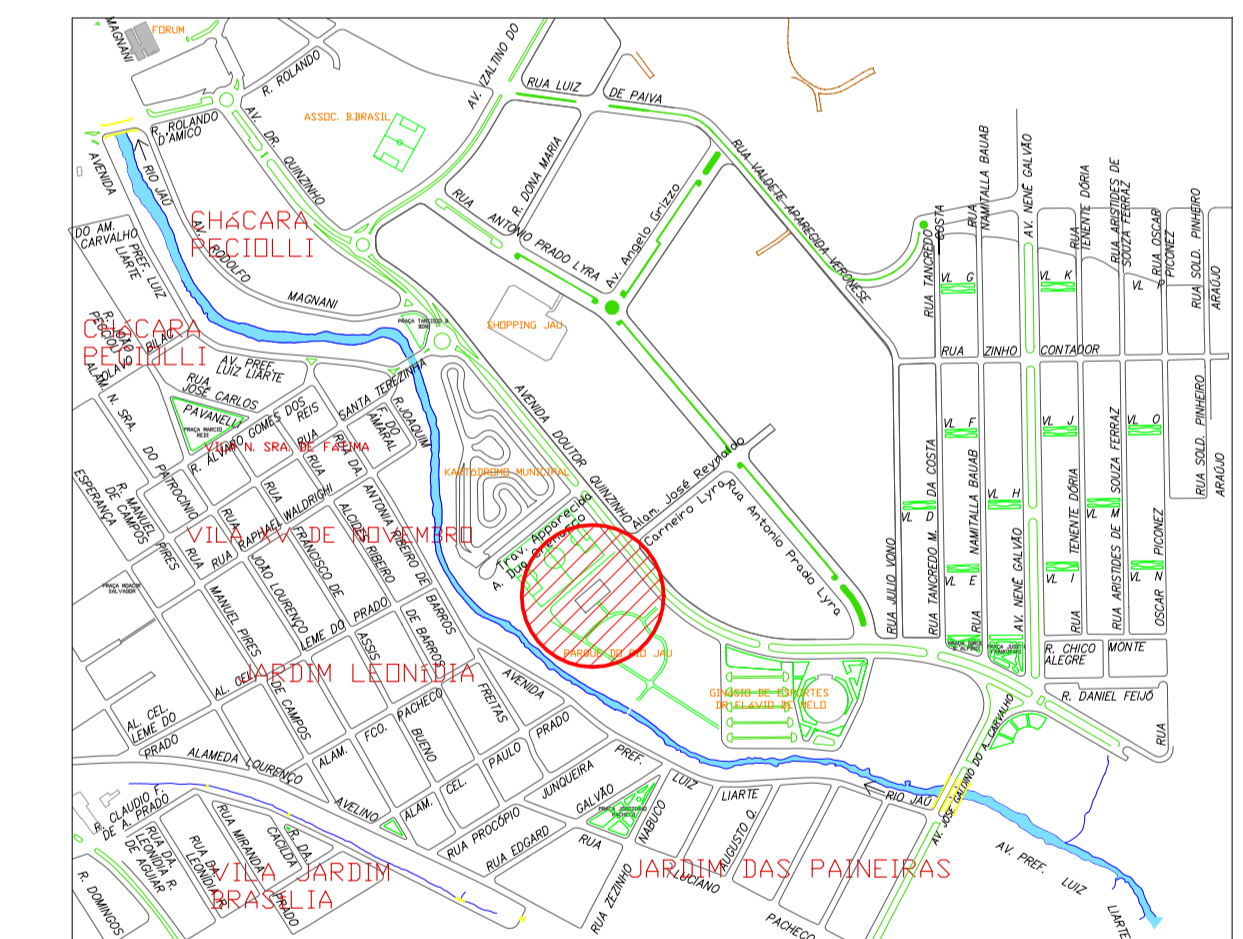

LOCALIZAÇÃO  
S/ Escala

PREFEITURA MUNICIPAL DE JAHU

SECRETARIA DE  
HABITAÇÃO E PLANEJAMENTO URBANÍSTICO



PROJETO  
**REVITALIZAÇÃO PISTA DE SKATE DO KARTÓDROMO**

LOCAL  
AV. DR. QUINZINHO - JAU/SP

PREFEITO MUNICIPAL

EDMAR BESSI COLAFATI  
ARQUITETO E URBANISTA

REFERÊNCIA  
ACESSO - ARQUIBANCADA - ENTORNO

Escala  
INDICADAS

Estudo  
Maio/2022  
Impressão  
Set/2023

Fl.  
03/04